

PORTLAND HARBOR CONSENT DECREE

APPENDIX A

Appendix A – City of Portland

The properties and facilities listed below are identified for the City of Portland for purposes of this Consent Decree. The City's released properties are identified by current tax parcel number from the Multnomah County Department of County Management Assessment and Taxation. However, unless otherwise indicated below, the property boundaries are based on the current tax parcel number and not the Site number. The City's released conveyance system facilities are indicated on the attached map and are identified by City of Portland outfall number (OF#) and encompass the City's associated facilities for each outfall inclusive of the collection facilities, treatment facilities and pump stations.

Site ID Number	County Tax Parcel ID (RNO)	Site ID Number	County Tax Parcel ID (RNO)
61	R118300200 R971350710	125	R961130010 R961130480
62	R971350340 R971350460	126	R739100250 R739100380 R739101160 R739101320
72	R961020380	127	R739100180 R961120390 R961120410 R961120990 R961121240 R961121420
112	R425800090 R425800110 R425800150 R425800170 R425800230 R425806020 R425806050 R425806160 R425806620 R425806900 R425807000 R425807250 R425807450 R425807470 R425807670	176	R649867690 R649867700 No RNO: 1N1E20-A-TR-A
124	R961130320 R961130040	190	R941201040

Site ID Number	County Tax Parcel ID (RNO)	Site ID Number	County Tax Parcel ID (RNO)
193	R941190770	607	R118300100
195	R649831490 R941211160	611	No Tax Id. Bonneville Power Right of Way at River Mile 3.4
213	R941280830 R941290860 R941290910 R941291030 R941291570 R941291580 R941291840	619	R941291580
222	R649671170 R766004790	622	R009618320 R009618330
278	R649729844 R941280350	652	R941292220
306	R115200010 R180236820 R180237020	213	R941280990
414	R009618170 R009618210 R009618290 R009618370 R009618510 R203800090 R204000100 R244901570 R244901590 R396201240 R553000700 R553000800 R553001000 R553001200 R553001510 R553001610 R553001620 R553001640 R903701740 R009618300 R244902190	279	R009617390
528	R941291830	279A	R009617400

Site ID Number	County Tax Parcel ID (RNO)	Site ID Number	County Tax Parcel ID (RNO)
279B	R009616030 R009616090	348B	R850600350 R850600400 R850600450
279C	R009616770	355J	R180200020
306A	R649812730 R649812740	465A	R850600050
306B	R850600150 R850600250 R850600300		
306C	R180217550 R180220230 R180236410 R180236460 R180237200 R180237360 R180237370 R793100300		
306D	R793100100 R793100150 R793100250 R793100350 R793100400		
306E	R180236250		
311C	R180217520 R180236470 R180217530 R180236400 R180236420 R180237210		
316D	R793100200		
316H/623H	R405840770		
334A	R649812750		
355K	R180200030		
336D	R793100050		



Appendix A
City of Portland
Released Conveyance System Map
 Settlement Confidential/ Subject to FRE 408

LEGEND

- City Outfall, Active
- City Outfall, Abandoned

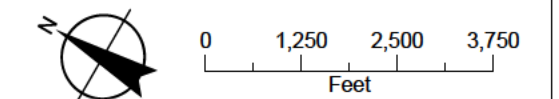
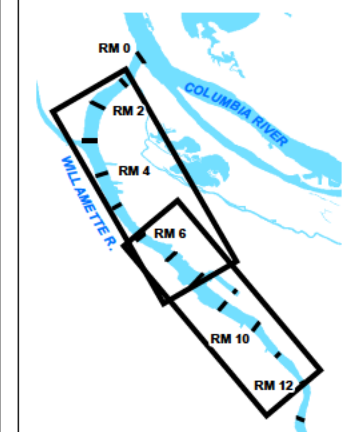

Date: October 5, 2021
 Data Sources: BES, Aerial COP 2020



Appendix A – EVRAZ Inc. NA

The properties listed below are identified for EVRAZ Inc. NA for purposes of settlement under this Consent Decree. Inclusion of a property or portion of a property in this chart should not be construed as an admission of liability for that parcel.

Properties are identified by current legal descriptions from the Multnomah County Department of County Management Assessment and Taxation. The attached Figures, and where available, the Site ID number, street address, and parcel identification number also are listed for each tax parcel, in order to provide additional context and reference.¹ However, unless otherwise indicated below, the property boundaries are based on the current legal description, not the Site number or the street address.

<u>Site ID number</u>	<u>Street Address</u>	<u>County Parcel ID</u>	<u>Legal Description</u>	<u>Notes</u>
157	5555 N. Channel Ave (Building #4)	R543777 (R649840290) R543779 (R649840291); R593920 (R649840292); R646345 (R649840293); R652118 (R649840298)	Partition Plat 2004-8, Lot 1, TL 301	
158	5851 N. Lagoon Avenue	R315645 (R941170730); R315646 (R941170731); R315691 (R941170890)	Section 17 1N 1E, TL 500; Section 17 1N 1E, TL 500 Section 17 1N 1E, TL 700	

¹ Multnomah County Parcel Identification Numbers are associated with a particular entity in addition to being associated with a parcel of land. Inclusion of one or more County Parcel ID numbers are intended only to aid in locating the parcel at issue in county records and are not intended to imply a relationship between EVRAZ Inc. NA and the particular Parcel ID number or any associated entity.

<u>Site ID number</u>	<u>Street Address</u>	<u>County Parcel ID</u>	<u>Legal Description</u>	<u>Notes</u>
160	5555 N. Channel Ave (Building #9)	R598050 (R649831527); R315940 (R941200830; currently part of Site 85); R540489 (R649831522) R315718 (R941171190) R315965 (R941201110) R315966 (R941201120) R315967 (R941201130) R315923 (R941200620) R315951 (R941200950) R316060 (R941210820) R490451 (R941201300) R316061 (R941210830) R236880 (R649704100) R238103 (R649735970)	Section 20 1N 1E, Partition Plot 2003-38, Lot 3, TL 108 Section 20 1N 1E, TL 200; Partition Plat 2003-38, Lot 3, TL 105 Section 17 1N 1E, TL 900 Section 20 1N 1E, TL 1000 Section 20 1N 1E, TL 900 Section 20 1N 1E, TL 800 Section 20 1N 1E, TL 200 Section 20 1N 1E, TL 1200 Section 21 1N 1E, TL 1100 Section 20 1N 1E, TL 1300 Section 21 1N 1E, TL 500 Partition Plat 1990-69, Lot 1, TL 100 Partition Plat 1993-150, Lot A	

<u>Site ID number</u>	<u>Street Address</u>	<u>County Parcel ID</u>	<u>Legal Description</u>	<u>Notes</u>
182	4950 NW Front Avenue; 5034 NW Front Avenue; 5200 NW Front Avenue; Unknown property address between 4927 NW Front Avenue and 4700 NW Front Avenue on west side of NW Front Avenue	R238223 (R649741630); R238218 (R649741610); R315893 (R941191230); R238220 (R649741620); R315838 (R941190540)	Partition Plat 1994-41, Lot 3 (Section 19A 1N, 1E TL 900); Partition Plat 1994-41, Lot 1 (Section 19A 1N 1E, TL 1000); Section 19 1N 1E, TL 100; Partition Plat 1994-41, Lot 2 (Section 19A 1N 1E, TL 1100); Section 19 1N 1E, TL 1500	Map provided for reference (Figure 3). Includes all docks, trestles, dolphins, pilings, water intake, equipment, and all other structures affixed thereto or otherwise appurtenant to property over time. Includes all related easements, permits, licenses, rights-of-way, or other possessory interests in other properties over time: an oil pipeline across Port of Portland property; road and railroad spur easements across 5480 NW Front Avenue; and a railroad spur easement across NW Front Avenue and 4700 NW Front Avenue.
142	6161 NW 61 st Avenue	R324191 (R961130130)	Section 13 1N 1W, TL 600	
13	14400 N. Rivergate Blvd	R239681 (R649774290)	Section 26, 2N 1W, Partition Plat 1997-108, Lot 1, TL 800	Map provided for reference (Figure 2). Includes all docks, trestles, dolphins, pilings, water intake, equipment, and structures affixed thereto or otherwise appurtenant to property over time. Includes easements and rights of way: track and rail easements and natural gas pipeline easements and rights of way across adjacent properties.

<u>Site ID number</u>	<u>Street Address</u>	<u>County Parcel ID</u>	<u>Legal Description</u>	<u>Notes</u>
60	9040 N. Burgard Way	R3225527 (R971350740)	Section 35 2N 1W, TL 300	
64	11920 N. Burgard Rd. 11920 WI / N. Burgard Rd.	R325486 (R971350130); R251997 (R687300050); R325491 (R971350260); R325532 (R971350770); R501677 (R971360410);	Section 35 2N 1W, TL 1200; RAMSEY VILLA AC, LOT F-H&J TL 600; Section 35 2N 1W TL 1500; Section 35 2N 1W TL 1400; Section 36 2N 1W TL 700	
73	11040 N. Lombard Port of Portland Terminal 4	POP Terminal 4 Berths 414/415 R323783 (R961020930); R537423 (R961021330); R323764 (R96102390); R323769 (R961020420); R323790 (R961021020) R324084 (R961110340); R323778 (R961020630)	Section 02 1N 1W, TL 300; Section 02 1N 1W, TL 800; Section 02 1N 1W, TL 1000; Section 02 1N 1W, TL 200; Section 02 1N 1W, TL 2400; Section 11 1N 1W, TL 100 Section 02 1N 1W, TL 900	

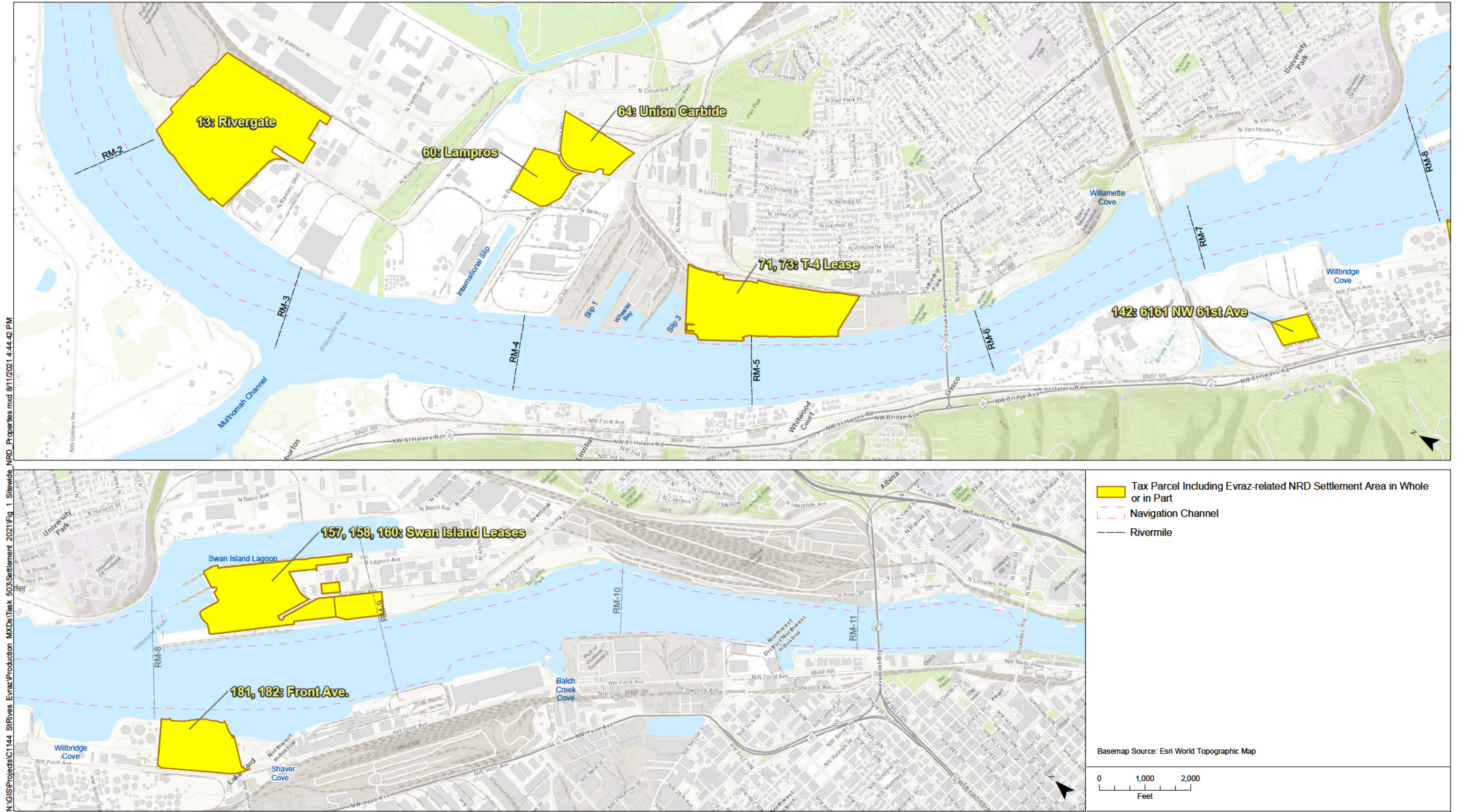

N:\GIS\Projects\C1144_SIRives_Evraz\Production_MXD\Task_503\Settlement_2021\Fig_1_SiteWide_NRD_Properties.mxd 8/11/2021 4:44:42 PM

Figure 1.
NRD Settlement Areas for Evraz-Related Properties

N:\GIS\Projects\C1144_SiRives_Evraz\Production_MXD\Task_503\Settlement_2021\Fig_2_Rivergate_Property.mxd 8/11/2021 5:14:27 PM



Figure 2.
Parcels Covered by Evraz NRD Settlement
Rivergate Property

N:\GIS\Projects\C1144_SiRives_Evraz\Production_MXD\Task_503\Settlement_2021\Fig_2_Front_Ave_Property.mxd 8/9/2021 10:07:47 AM



Figure 3.
Parcels Covered by Evraz NRD Settlement
Front Ave. Property

Appendix A – MMGL LLC

The properties listed below are identified for MMGL LLC for purposes of this Consent Decree. Properties are identified by current tax parcel number from the Multnomah County Department of County Management Assessment and Taxation. Where available, the Site ID number and street address also are listed for each tax parcel, in order to provide additional context and reference. However, unless otherwise indicated below, the property boundaries are based on the current tax parcel number, not the Site number or the street address.

Site ID number	Street Address	County Tax Parcel ID
51	10350 N. Time Oil Road	R971350650, R971350620, R971350630, R971350180, R971350310, R971350600, R971350380
52	9125 N. Time Oil Road, 9449 N. Burgard Way, 9945 N. Burgard Way, 10400 N. Burgard Way, 12005 N. Burgard Road	R971350570, R971350550, R971350760, R971350560, R118300300, R118300010, R118300900, R118300700, R118300800, R971350571
55	9333 N. Time Oil Road	R118301000
56	9449 N. Burgard Way	R118300400, R118300500, R118300600
60	9040 N. Burgard Way	R971350740
61	12005 N. Burgard Road	R971350710, R118300200
109	8940/8970 N. Bradford Street	R425807870
141	6529 NW Front Ave.	R961130330
158	5851 N. Lagoon Ave.	R941170730, R941170890
186	4250 NW Front Ave. (former address of relevant portion of Site 186, all of which is now addressed as 4700 NW Front Ave.)	R941200570, R941191240, R941200500, R941191190
203	3200-3340 NW Yeon Ave., 3340-3342 NW 26 th Ave.	R649701500, R941291430, R649701480, R649701460, R934690010, R941280990, R941280950
204	3721 NW Front Ave.	R941200220
205	3641/3683 NW Front Ave.	R941200980
209	3333 NW Front Ave.	R941280470
near 227	2262 NW Nicolai Street	Formerly R766002340, now occupied by a portion of U.S. Route 30
329	1415 NW 12 th Ave.	R180221780
533	3033 NW Yeon Ave.	R941290860
546	4319 NW Yeon Ave.	R649704660
547	4110 NW St. Helens Road/4285 NW Yeon Ave.	R941190130
565	4325-4347 NW Yeon Ave.	R649704640

Site ID number	Street Address	County Tax Parcel ID
589	3720 NW Yeon Ave.	R941291670
590	3055-3061 NW Yeon Ave.	R941290960
607	12005 N. Burgard Road	R118300100
608	4931-5043 NW Front Ave.	R941190500
609	2531-2535 NW 28 th Ave.	R414900490
648	2000/2019 NW Wilson Street	R766000300
649	2306 NW Reed Street	R215300840
650	2321-2337 NW York Street	R215300810, R215300890
651	3738 NW Yeon Ave.	R941290800

Appendix A - PacifiCorp**PacifiCorp Currently Owned/Operated Properties**Properties associated with specific tax parcels

Property Description	Address	Property ID	State ID	County Tax Alternate Account No.
Albina Substation (Blocks 71, 81 and 82, Albina)	Between N. Lewis and N. Harding Avenue, and between N. River and N. Railroad Streets	R102677 (Block 71)	1N1E27CB - 01000	R009616420
		R102695 (Block 81)	1N1E27CB - 01200	R009617190
		R102696 (Block 82)	1N1E27CB - 01100	R009617290
Knott Substation (Portions of Blocks 26 & 27, Albina)	West of NE Rodney Ave., between NE Russell St. and NE Knott St. (91 NE Russell St.)	R102427	1N1E27AD - 16700	R009610170
		R102428	1N1E27AD - 16600	R009610180
		R102429	1N1E27AD - 16800	R009610190
		R102430	1N1E27AD - 16500	R009610200
		R102431	1N1E27AD - 16400	R009610210
		R102432	1N1E27AD - 16300	R009610220
		R102433	1N1E27AD - 16200	R009610230
		R102434	1N1E27AD - 16100	R009610240
		R102435	1N1E27AD - 16000	R009610250
		R102437	1N1E27AD - 15800	R009610360

Property Description	Address	Property ID	State ID	County Tax Alternate Account No.
Knott Substation (Portions of Blocks 26 & 27, Albina)	West of NE Rodney Ave., between NE Russell St. and NE Knott St. (91 NE Russell St.)	R102438	1N1E27AD - 15600	R009610450
		R102439	1N1E27AD - 15700	R009610460
Lincoln Substation, South Waterfront Extension	2477 S Moody Ave.	R273075 (property) / R273076 (easement)	1S1E03CD - 00901 / 1S1E03CD - 00901-A1	R779900360 / R779900361

Other Properties

Transmission and Distribution System, Albina, Lincoln and Downtown Districts

Facilities and service areas identified in attached Exhibits A-1 and A-2, including poles, towers, transmission and distribution lines, submarine cable crossings and transformers.

PacifiCorp Formerly Owned/Operated Properties

Property Description	Address	Property ID	State ID	County Tax Alternate Account No.
Block 69, Albina, Lots 7 & 8	2170 – 2182 N. Lewis Ave.	R102675	1N1E27CA - 06000	R009616320
Block 78, Albina	1303 S/ N River St.	R102691	1N1E27CB - 02600	R009616890
	1303 W/ N River St.	R102692	1N1E27CB - 02500	R009616900
Block 79, Albina	2223 N. Randolph Ave.	R102693	1N1E27CB - 01400	R009616990
Block 80, Albina	2204 N. Randolph Ave.	R102694	1N1E27CB - 01300	R009617100
Block 83, Albina	2110 N. Lewis Ave.	R102697	1N1E27CA - 06400	R009617390
		R532607	1N1E27CA - 06401	R009617400
		N. Tillamook St. Ramp (no Tax Parcel)		
Former Lincoln Station (PacifiCorp ownership areas as depicted in attached Exhibit A-3)	Foot of SW Lincoln Street	R238252	1S1E03CD - 00300	R649742170
		R238253	1S1E03CD - 00200	R649742180
		R246187 (Portion)	1S1E03CA - 01000	R667709440
		R273071	1S1E03CD - 00500	R779900200

Property Description	Address	Property ID	State ID	County Tax Alternate Account No.
Former Lincoln Station (PacifiCorp ownership areas as depicted in attached Exhibit A-3)	Foot of SW Lincoln Street	R273073	1S1E03CD - 00800	R779900300
		R273074	1S1E03CD - 00900	R779900350
		R273075	1S1E03CD - 00901	R779900360
		R273076	1S1E03CD - 00901-A1	R779900361
		R273077 (Portion)	1S1E03CD - 01000	R779900400
		R326736 (Portion)	1S1E03CA - 01200	R991030290
		R487357	1S1E03CD - 00102	R649795140
		R592350	1S1E03CD - 90000	R799400010

PacifiCorp
Exhibit A-1
Albina District
Transmission and Distribution
System Facilities

- Legend**
- + River Mile
 - Facility Points**
 - Pole Mounted Transformer
 - ▲ Pad Mounted Transformers
 - ⊠ Underground Transformers
 - Distribution Structure
 - Transmission Structure
 - Distribution Primary Lines
 - Distribution Secondary Lines
 - Transmission Lines**
 - ▬ PacifiCorp Owned
 - Service Areas**
 - ▭ Albina - PacifiCorp

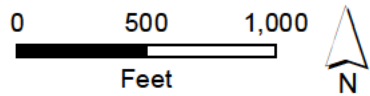
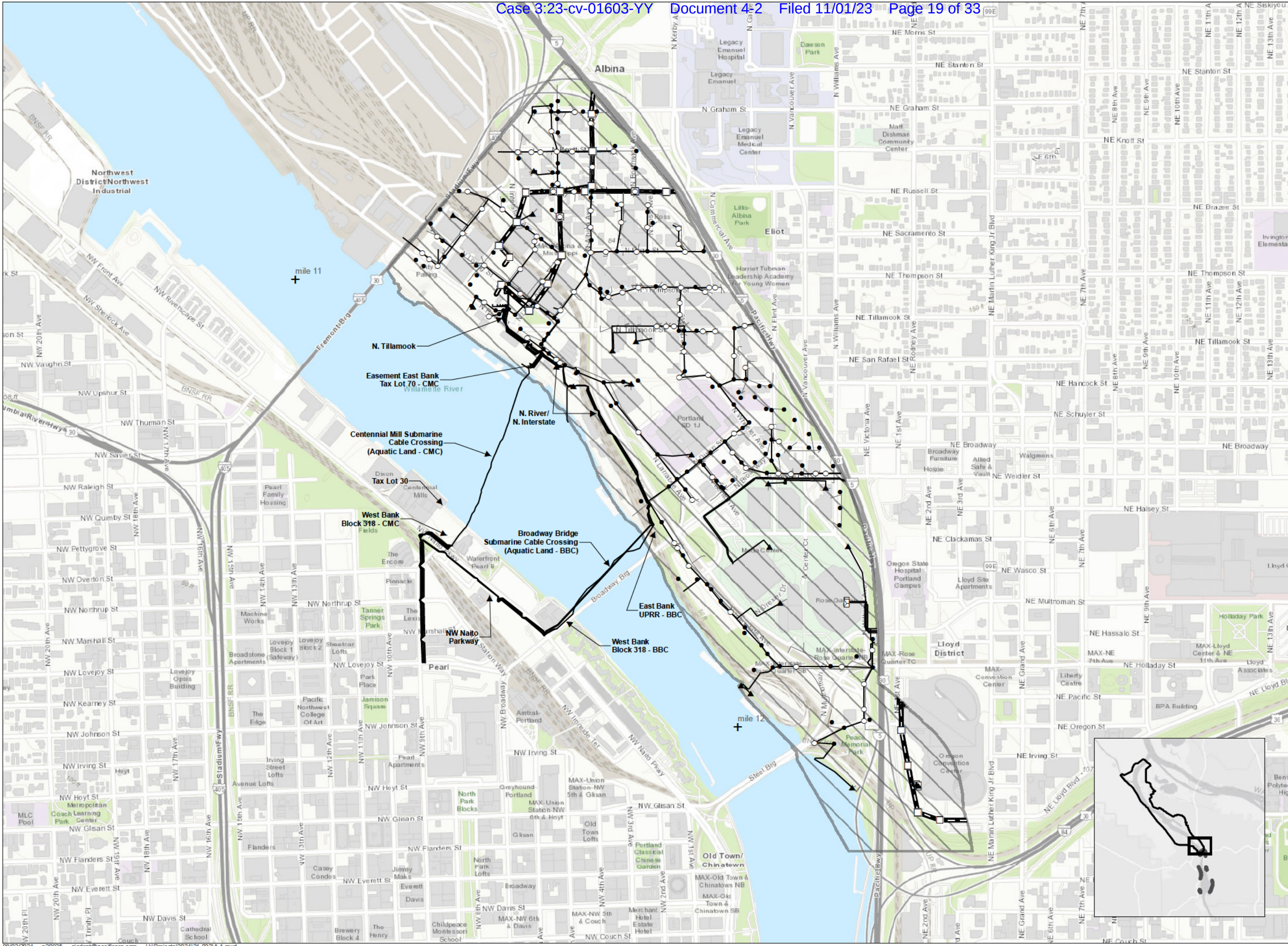

PACIFICORP
 GIS SUPPORT SERVICES
 Solutions Group
 gisdept@pacifiCorp.com

Data is projected in UTM Zone 10, NAD83, meters.

PacifiCorp makes no representations or warranties as to the accuracy, completeness or fitness for a particular purpose with respect to the information contained in this map. PacifiCorp shall have no responsibility or liability to any person or entity resulting from the use of any information furnished in his map.

Service Layer Credits: Sources: Esri, HERE, Garmin, Intermap, increment P Corp., GEBCO, USGS, FAO, NPS, NRCAN, GeoBase, IGN, Kadaster NL, Ordnance Survey, Esri Japan, METI, Esri China (Hong Kong), swisstopo, © OpenStreetMap contributors, and the GIS User

PacifiCorp
Exhibit A-2

Lincoln and Downtown District
Transmission and Distribution
System Facilities

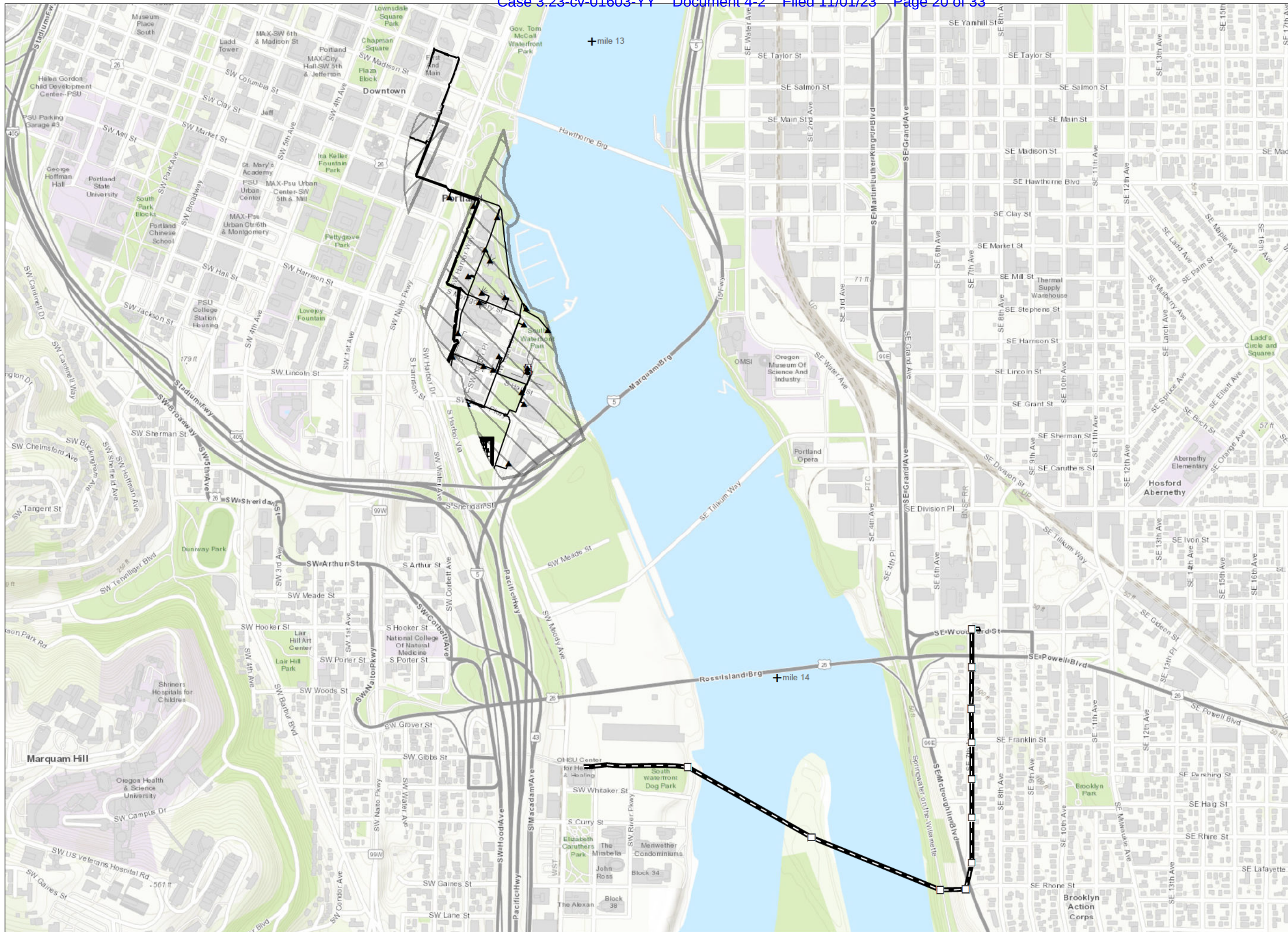

- + River Mile
- Facility Points**
- ▲ Pad Mounted Transformers
- ▣ Underground Transformers
- Transmission Structure
- Distribution Primary Lines
- Distribution Secondary Lines
- Transmission Lines**
- PacifiCorp Owned
- Service Areas**
- ▭ Lincoln - PacifiCorp (Parcel B)
- ▭ Downtown Core - Shared (Parcel D)

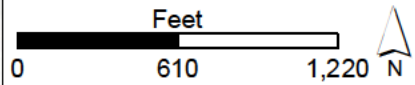

Data is projected in UTM Zone 10, NAD83, meters.

PacifiCorp makes no representations or warranties as to the accuracy, completeness or fitness for a particular purpose with respect to the information contained in this map. PacifiCorp shall have no responsibility or liability to any person or entity resulting from the use of any information furnished in this map.

Service Layer Credits: Sources: Esri, HERE, Garmin, Intermap, increment P Corp., GEBCO, USGS, FAO, NPS, NRCAN, GeoBase, IGN, Kadaster NL, Ordnance Survey, Esri Japan, METI, Esri China (Hong Kong), swisstopo, © OpenStreetMap contributors, and the GIS User

Appendix A – Port of Portland

The properties listed below are identified for Port of Portland for purposes of this Consent Decree, along with: (a) any docks, dry docks, wharves, berths, or other structures (or equipment on them), that extended or extend from any of the listed properties into or over the waters of the Willamette River; and (b) any immediately adjacent areas formerly owned by the Port that became roads, streets, railroads, or rights-of-way (that may or may not have tax parcel numbers). Properties listed below are identified by current tax parcel number from the Multnomah County Department of County Management Assessment and Taxation. Where applicable, the "Formerly Known As" column identifies former parcel numbers that have cancelled into the listed current parcel number or provides other clarifying information. Where available, the Site ID number and street address are also listed for each tax parcel, in order to provide additional context and reference. However, unless otherwise indicated below, the property boundaries are based on the current tax parcel number, not the Site number or the street address.

Site ID ¹	Mult Co Alt Act#	Address ²	Formerly Known As ³
8	R708881588	15660 N LOMBARD ST	
8	R708881940	15660 N LOMBARD ST	R708882420; R708882440, R708882430
8	R708881600	15660 N LOMBARD ST	
8	R708882410	15660 N LOMBARD ST	
8	R708881908	15660 N LOMBARD ST	
8	R708881890	15660 N LOMBARD ST	
8	R708881960	15660 N LOMBARD ST	R708881880; R708881950; R708881930
8	R708882620	15660 N LOMBARD ST	
8	R708882850	15660 N LOMBARD ST	
8	R708881910	15660 N LOMBARD ST	
8	R708880036	15660 N LOMBARD ST	
8	R708881584	15660 N LOMBARD ST	R708881582
8	R708892700	15660 N LOMBARD ST	R708880020
8	R708881870	15660 N LOMBARD ST	
8	R708881900	15660 N LOMBARD ST	
8	R708881590	15660 N LOMBARD ST	
8	R708882200	15660 N LOMBARD ST	
13	R649774290	14400 N RIVERGATE BLVD	
17	R971260240	14003 N RIVERGATE BLVD	
17	R971260310	14003 N RIVERGATE BLVD	
18	R971260260	14025 N RIVERGATE BLVD	
21	R971260190	13939 N RIVERGATE BLVD	
22	R708882760	SWC/ RAMSEY & N RIVERGATE BLVD	
22	R708883810	9639 N RIVERGATE BLVD	
22	R708887010	13333 WI/ N RIVERGATE BLVD	

Site ID ¹	Mult Co Alt Act#	Address ²	Formerly Known As ³
22	R708882700	9699 S/ N RIVERGATE BLVD	
22	R708882770	LEVY CODE 201	
22	R708883800	9619 N RIVERGATE BLVD	
22	R708882666	LEVY CODE 201	
22	R708887100	13035 N RIVERGATE BLVD	
22	R708886700	LEVY CODE 201	
22	R708887220	N TIME OIL RD	
22	R708886500	LEVY CODE 201	
22	R708886510	LEVY CODE 201	
22	R708882680	LEVY CODE 201	
22	R708886600	13333 N RIVERGATE BLVD	
22	R971260030	13333 N RIVERGATE BLVD	
22	R708882800	13333 N RIVERGATE BLVD	
22	R708880040	13333 N RIVERGATE BLVD	
22	R359500020	13333 N RIVERGATE BLVD	
22	R708887000	13333 N RIVERGATE BLVD	
22	R708883840	13333 N RIVERGATE BLVD	
22	R708883830	9639 N RIVERGATE BLVD	
22	R708890250	9333 N RIVERGATE BLVD	
22	R708884120	LEVY CODE 201	
22	R971260340	LEVY CODE 201	
22	R708882740	W END/ N RAMSEY BLVD	
22	R359500100	9345 N HARBORGATE ST	
24	R971260200	13940 N RIVERGATE BLVD	
24	R708884300	9715 N RAMSEY BLVD	R971260210
47	R971350100	LEVY CODE 201	
48	R708887200	13035 N RIVERGATE BLVD	
71	R971350540	11040 N LOMBARD ST/TERMINAL 4	
71	R971350250	11041 N LOMBARD ST/TERMINAL 4	
71	R971350240	11040 N LOMBARD ST/LEVY CODE 201	
71	R961021100	11040 N LOMBARD ST	R961021280, R961021350, R961021200, R961021360
71	R961020410	11041 N LOMBARD ST/TERMINAL 4	
71	R961021030	11042 N LOMBARD ST/TERMINAL 4	
71	R961020960	11044 N LOMBARD ST/TERMINAL 4	

Site ID ¹	Mult Co Alt Act#	Address ²	Formerly Known As ³
71	R961020910	11045 N LOMBARD ST/TERMINAL 4	
71	R961021260	11040 N LOMBARD ST	R961021270
71	R961021370	11040 N LOMBARD ST	
71	R961021230	11040 N LOMBARD ST	
71	R961021240	11040 N LOMBARD ST	
71	R961020420	11040 N LOMBARD ST/TERMINAL 4	
71	R961021250	11040 WI/ N LOMBARD ST	
73	R961020390	11020 N LOMBARD ST	
73	R961021330	11020 N LOMBARD ST	R961021340
73	R961020930	N BRADFORD ST	
73	R961021020	TERMINAL 4	
73	R961021190	LEVY CODE 201	
73	R961020630	N BRADFORD ST	
73	R961110340	N BRADFORD ST	
73	R961110450	11020 N LOMBARD ST	
73	R961021130	10400 N LOMBARD ST	
108	R961110010	8940 N BRADFORD ST	
108	R961110360	8940 N BRADFORD ST	
127	R961120390	S/ N PIERCE AVE (FORMER POP PROPERTY)	
127	R961120410	SEC/ RICHMOND & N BRADFORD ST (METRO)	
127	R961120990	N VAN BUREN AVE (METRO)	
127	R961121240	N VAN BUREN AVE (METRO)	
127	R961121420	S/ N WILLAMETTE BLVD	
127	R739100180	SWC/ BRADFORD & N RICHMOND AVE (METRO)	
133	R941180200	6080 WI/ NW FRONT AVE	R941180060
136	R941190960	5700 NW FRONT AVE	
136	R941180170	5724-5740 NW FRONT AVE	
136	R941191270	5480 WI/ NW FRONT AVE	
136	R941180260	5480 WI/ NW FRONT AVE	
143	R941180050	5533 WI/ NW DOANE AVE	
144	R941180040	5528 NW DOANE AVE	
157	R941180390	5555 N CHANNEL AVE	
157	R649840290	5555 N CHANNEL AVE	R649831524
157	R941201320	5555 N CHANNEL AVE	

Site ID ¹	Mult Co Alt Act#	Address ²	Formerly Known As ³
160	R649831522	5225 N CHANNEL AVE	R649831526
160	R649831527	5225 N CHANNEL AVE	
160	R941201120	N CHANNEL AVE	
160	R649831508	N CHANNEL AVE	
160	R941201130	N CHANNEL AVE	
160	R941200620	4855 N LAGOON AVE	
160	R941210030	SE COR/ BASIN & N WYGANT ST	
160	R814680150	N CHANNEL AVE	R649831500 (See Footnote 13)
160	R941200950	4660 N CHANNEL AVE / 4085 N ANCHOR ST	R941201060, R941201050
160	R941210820	4703-4715 N LAGOON AVE	R941200900, R941211050
160	R941201300	4703-4715 W/ N LAGOON AVE	
160	R814680200	N CHANNEL AVE	R649831494, R814680400, R814680450
160	R941210830	NW COR/ BASIN & N GOING ST	
160	R649735970	N CHANNEL AVE / 4344 N/ N PORT CENTER WAY	
160	R649704100	3110 N GOING ST	
160	R814680404	4435-4747 N CHANNEL AVE	R649831511; R814680300; R814680354, R649831506, R649831514, R649831504, R649831502
160	R814680204	4555 N CHANNEL AVE	R649831513; R814680354
160	R814680050	4435-4747 N CHANNEL AVE	R649831516, R649831510, R649831512
160	R941171190	S SIDE/ N DOLPHIN ST	R941201240, R941201270
160	R941201110	N CHANNEL AVE	
163	R941200890	5405 N LAGOON AVE	
164	R025800060	7007 S/ N CUTTER CIR	
164	R025800080	7008 S/ N CUTTER CIR	
164	R941170880	6936 N FATHOM ST	
164	R941171360	6936 WI/ N FATHOM ST	
165	R649840324	5420 N LAGOON AVE	
165	R649840300	5420 N LAGOON AVE	
171	R649755370	5036 N LAGOON AVE	
175	R941200680	4859 N LAGOON AVE	
175	R941200720	5001 N LAGOON AVE	
181	R941191230	5034 WI/ NW FRONT AVE	
182	R649741610	5034 NW FRONT AVE	
182	R649741630	4950 NW FRONT AVE	

Site ID ¹	Mult Co Alt Act#	Address ²	Formerly Known As ³
186	R941200570	4700 WI/ NW FRONT AVE	
188	R941200650	3838 NW FRONT AVE	
191	R941180140	5501 NW FRONT AVE	
191	R941190640	5501 NW FRONT AVE	
195	R649831490	4099 N PORT CENTER WAY	
197	R941190600	LEVY CODE 001	
207	R941291980	3445-3455 NW FRONT AVE	
218	R941201280	3556 NW FRONT AVE	
218	R941280500	3556 WI/ NW FRONT AVE	
218	R941280820	3556 WI/ NW FRONT AVE / 2800 N/ NW FRONT AVE	
218	R941280710	3556 WI/ NW FRONT AVE	
218	R941292160	NW FRONT AVE	
218	R941280650	3556 WI/ NW FRONT AVE	
218	R941280630	3060-3556 NW FRONT AVE	
218	R941280440	3556 WI/ NW FRONT AVE	
218	R941280590	NW SHERLOCK AVE	
222	R766004790	2400 NW FRONT AVE	
231	R941170920	6767 N BASIN AVE	
231	R941170940	6735 N BASIN AVE	
232	R941171010	6211 N ENSIGN ST	
234	R941171120	6208 S/ N ENSIGN ST	
234	R941171030	6208 N ENSIGN ST	
236	R941170520	6147 N BASIN AVE	
236	R941171290	6135 N BASIN AVE	
237	R941170590	5949 N BASIN AVE	See Footnote 4
238	R941171260	5617-5885 N BASIN AVE	
248	R941170560	5926-5938 N BASIN AVE	R941170550
249	R941170540	5820 N BASIN AVE	
250	R941160200	5500 N BASIN AVE	
263	R605604000	6845 N CUTTER CIR	
303	R708820010	1700 NW RIVERSCAPE ST	
303	R637100010	1830 NW RIVERSCAPE DR	
303	R768100010	NW RIVERSCAPE ST	
303	R708970150	NW FRONT AVE / 1850 NW FRONT AVE	
303	R708970010	NW FRONT AVE	
303	R708970270	NW 16TH AVE	See Footnote 5
303	R708970040	NW 16TH AVE	

Site ID ¹	Mult Co Alt Act#	Address ²	Formerly Known As ³
303	R708970050	NW 16TH AVE	
303	R708970110	E/ NW FRONT AVE	
303	R708970100	E/ NW FRONT AVE	
303	R708970060	NW RIVERSCAPE ST	
303	R708970080	NW RIVERSCAPE ST	
303	R708970500	NWC/ 18TH & NW FRONT AVE / 2220 NW FRONT AVE	
303	R708970550	NW FRONT AVE / 2130 NW FRONT AVE	
303	R708970600	NW FRONT AVE / 2080 NW FRONT AVE	
303	R708970650	NW FRONT AVE / 2010 NW FRONT AVE	R708970700
303	R766004290	PART/ TERMINAL 1 SOUTH	
303	R708970020	1648 NW RIVERSCAPE ST / NW 16TH AVE	
303	R708970350	1648 NW RIVERSCAPE ST	See Footnote 6
303	R708970400	1648 NW RIVERSCAPE ST	See Footnote 7
303	R708970070	1648 NW RIVERSCAPE ST	
303	R708970250	1648 NW RIVERSCAPE ST	See Footnote 8
303	R708970450	1648 NW RIVERSCAPE ST	See Footnote 9
303	R708970090	1648 NW RIVERSCAPE ST	See Footnote 10
303	R708970300	1648 NW RIVERSCAPE ST	See Footnote 11
309	R180235990	1030 NW NAITO PKWY	
596	R941160220	5400 N/ N EMERSON ST	
596	R941160230	5400 N/ N EMERSON ST	
596	R941210560	5400 N BASIN AVE	
596	R941160210	5400 N/ N BASIN AVE	
596	R941211100	5400 WI/ N BASIN AVE	
596	R941200840	5400 WI/ N BASIN AVE	
597	R941201180	5161 WI/ N LAGOON AVE	
597	R941200910	5161 WI/ N LAGOON AVE	
597	R941200760	5161 N LAGOON AVE	
597	R941200920	5160 N LAGOON AVE	
76L	R941210510	LEVY CODE 710	
76L	R649729810	N PORT CENTER WAY	
277L	R941280920	LEVY CODE 201	
None	R941200060	3710 NW FRONT AVE	P120035701
None	R605600020	S SIDE/ N WILLAMETTE BLVD	R025800021

Site ID ¹	Mult Co Alt Act#	Address ²	Formerly Known As ³
None	R649680490	N CUTTER CIR	R025800020, R025800040 (See Footnote 12)
None	R359500050	9310 N HARBORGATE ST	
None	R359500150	9333 N HARBORGATE ST	
None	R359500200	9442 N RAMSEY BLVD	
None	R605600080	5910 N CUTTER CIR	
None	R605600160	6000-6020 N CUTTER CIR	
None	R605600340	6032-6220 N CUTTER CIR	
None	R605600390	6330 N CUTTER CIR	
None	R605600400	6712 N CUTTER CIR	
None	R605601980	6121 N CUTTER CIR	
None	R605602000	6421 N CUTTER CIR	
None	R605602020	6235 N CUTTER CIR	
None	R605602021	6235 WI/ N CUTTER CIR	
None	R605602060	3620 N LEVERMAN ST	
None	R605602200	6400 N CUTTER CIR	
None	R605603500	6800-6840 N CUTTER CIR	
None	R605604700	6447 N CUTTER CIR	
None	R637101610	BLANK	
None	R649732010	5909 N CUTTER CIR	
None	R649732020	5937 N CUTTER CIR	
None	R649735960	4344 N PORT CENTER WAY	
None	R649744600	2435 NW FRONT AVE	
None	R649744630	2303 NW FRONT AVE	
None	R649746970	3449-3627 N ANCHOR ST	
None	R649746980	3449-3627 WI/ N ANCHOR ST	
None	R649774295	14400 WI/ N RIVERGATE BLVD	
None	R649774300	14141 N RIVERGATE BLVD	
None	R649845770	5018 N CHANNEL AVE BLDG #1	
None	R649845780	5016 N CHANNEL AVE	
None	R649867690	3737 N EMERSON ST	
None	R649867700	N BASIN AVE	
None	R708881120	9200 WI/ N RAMSEY BLVD	
None	R708881140	9200 N RAMSEY BLVD	
None	R708881594	15840 WI/ N SIMMONS RD	
None	R708881596	LEVY CODE 393	

Site ID ¹	Mult Co Alt Act#	Address ²	Formerly Known As ³
None	R708882240	15831 N SIMMONS RD	
None	R708882260	15840 WI/ N SIMMONS RD	
None	R708882300	16120 N SIMMONS RD	
None	R708882870	15840 N SIMMONS RD	
None	R708883700	9211 N HARBORGATE ST	
None	R708883900	10001 N RIVERGATE BLVD	
None	R708884100	9625 N RAMSEY BLVD	
None	R708890050	9222 N HARBORGATE ST	
None	R708890150	9243 N RIVERGATE BLVD	
None	R708890170	13225 N LOMBARD ST	
None	R708892300	14819 WI/ N LOMBARD ST	
None	R708892400	14819 N LOMBARD ST	
None	R708892600	15011 N LOMBARD ST	
None	R766003220	NWC/ 21ST & NW FRONT AVE	
None	R882434320	BLANK	
None	R941170570	5550 N BASIN AVE	
None	R941170580	6100 N BASIN AVE	
None	R941170610	6220 N BASIN AVE	
None	R941170620	5555 N LAGOON AVE	
None	R941170680	6290 N BASIN AVE	
None	R941170730	5851 WI/ N LAGOON AVE	
None	R941170740	6310 N BASIN AVE	
None	R941170830	5565 N DOLPHIN ST	
None	R941170860	6457 N BASIN AVE	
None	R941170870	6650 N ENSIGN ST	
None	R941170890	5851 WI/ N LAGOON AVE	
None	R941170900	6520 N BASIN AVE	
None	R941170910	6707 N BASIN AVE	
None	R941170930	6645 N ENSIGN ST	
None	R941170970	6650-6720 N BASIN AVE	
None	R941171000	NWC/ BASIN & N FATHOM ST	
None	R941171070	6870-6874 N FATHOM ST	
None	R941171080	5550 WI/ N BASIN AVE	
None	R941171130	6330-6340 N BASIN AVE	
None	R941171150	S/ N WILLAMETTE BLVD	
None	R941171200	6335 N BASIN AVE	
None	R941171210	6707 WI/ N BASIN AVE	

Site ID ¹	Mult Co Alt Act#	Address ²	Formerly Known As ³
None	R941171220	6840 N FATHOM ST	
None	R941171230	6125-6235 N BASIN AVE	
None	R941190290	4322-4338 NW YEON AVE	
None	R941200220	3721 NW FRONT AVE	
None	R941200700	3838 N BALLAST ST	
None	R941200730	4750 N CHANNEL AVE	
None	R941200740	4865 N LAGOON AVE	
None	R941200750	3919 N BALLAST ST	
None	R941200780	5020 N CHANNEL AVE	
None	R941200790	5061 N LAGOON AVE	
None	R941200800	5411 N LAGOON AVE	
None	R941200820	5051 N LAGOON AVE	
None	R941200830	5300-5350 N CHANNEL AVE	R941200860
None	R941200850	4800 N CHANNEL AVE	
None	R941200960	4325 N COMMERCE ST	
None	R941200970	5140 N CHANNEL AVE	
None	R941200980	3641-3683 NW FRONT AVE	
None	R941210850	4810 N BASIN AVE	
None	R941210870	3002-3014 N WYGANT ST	
None	R941210980	4810 WI/ N BASIN AVE	
None	R941211000	4730 N LAGOON AVE	
None	R941211010	4711 N BASIN AVE	
None	R941211020	4711 WI/ N BASIN AVE	
None	R941211110	4805-4825 N BASIN AVE	
None	R941280320	2901 NW FRONT AVE	
None	R941280930	3045-3065 WI/ NW FRONT AVE	
None	R941290570	3501-3599 NW YEON AVE	
None	R941290830	3551 NW FRONT AVE	
None	R941291070	3150 NW 31ST AVE	
None	R941291990	NW 26TH DRIVE	See Footnote 14
None	R961021140	10400 N LOMBARD ST	
None	R961021210	6921-7011 N ROBERTS AVE	
None	R971230030	LEVY CODE 393	
None	R971230050	LEVY CODE 393	
None	R941190450	4927 NW FRONT AVE	R941200930
None	R605600030	W SIDE/ N WILLAMETTE BLVD	

Site ID ¹	Mult Co Alt Act#	Address ²	Formerly Known As ³
None	R605600040	S SIDE/ N WILLAMETTE BLVD	
None	R605600070	6800 S/ N CUTTER CIR	
None	R605600100	N CUTTER CIR	
None	R605600120	N BASIN AVE	
None	R605600200	N CUTTER CIR	
None	R605600380	W SIDE/ N WILLAMETTE BLVD	
None	R605602210	W SIDE/ N LEVERMAN ST	
None	R941171100	NEC/ EMERSON & N BASIN AVE	
None	R941171110	6290 NE/ N BASIN AVE	
None	R941171140	6645 E/ N ENSIGN ST	
None	R941210430	5239 N/ N EMERSON DR	
FOOTNOTES			
1	Site ID: Site ID number from Trustees' Portland Harbor Allocation Site List.		
2	Address: From Port GIS database and/or Multnomah Co tax lot database.		
3	"Formerly Known As" column identifies former parcel numbers that have cancelled into the listed current parcel number		
4	R941170590; This lot merged into "Partition Plat 2016-10" in 2016		
5	R708970270; This lot merged into "Shoreline Condominiums" in 2006		
6	R708970350; This lot merged into "Shoreline Condominiums" in 2008		
7	R708970400; This lot merged into "Riverfront Place Condominium" in 2011		
8	R708970250; This lot merged into "Shoreline Condominiums Stage 2" in 2006		
9	R708970450; This lot merged into "Pacifica at Riverscape Condominiums" in 2008		
10	R708970090; This lot merged into "Pacifica at Riverscape Condominiums in 2008		
11	R708970300; This lot merged into "Shoreline Condominiums Stage 3" in 2007		
12	R025800020; This lot merged into "Partition Plat 2017-13" in 2017		
13	R649831500; This lot merged into "Swan Island Port Center Campus" in 2019		
14	R941291990; This lot merged into the north end of NW 26th Drive (street)		

Appendix A – Schnitzer Steel Industries, Inc.

The properties listed below are identified for Schnitzer Steel Industries, Inc. for purposes of this Consent Decree. Properties are identified by current tax parcel number from the Multnomah County Department of County Management Assessment and Taxation. Where available, the Site ID number and street address also are listed for each tax parcel, in order to provide additional context and reference. However, unless otherwise indicated below, the property boundaries are based on the current tax parcel number, not the Site number or the street address.

Site ID number	Street Address	County Tax Parcel ID
60	9040 N. Burgard Way	R971350740
61	12005 N. Burgard Road	R971350710, R118300200
141	6529 NW Front Ave.	R961130330
157	5555 N. Channel Ave.	R649840290, R941180390, R941201320
158	5851 N. Lagoon Ave.	R941170730, R941170890
186	4250 NW Front Ave. (former address of relevant portion of Site 186, all of which is now addressed as 4700 NW Front Ave.)	R941200570, R941191240, R941200500, R941191190
203	3200-3340 NW Yeon Ave., 3340-3342 NW 26 th Ave.	R649701500, R941291430, R649701480, R934690010, R941280990, R941280950, R649701460
204	3721 NW Front Ave.	R941200220
205	3641/3683 NW Front Ave.	R941200980
501	3333 NW 35 th Ave.	R941290710, R941291550, R941290720
607	12005 N. Burgard Road	R118300100

Appendix A – Siltronic Corporation

The properties listed below are identified for Siltronic Corporation for purposes of this Consent Decree. Properties are identified by current tax parcel number from the Multnomah County Department of County Management Assessment and Taxation. Where available, the Site ID number and street address also are listed for each tax parcel, in order to provide additional context and reference. However, unless otherwise indicated below, the property boundaries are based on the current tax parcel number, not the Site number or the street address.

Site ID number	Street Address	County Tax Parcel ID/Alternative Acct. No.
125	7200 NW Front Ave.	R324183/R961130010
125	7200 NW Front Ave.	R324219/R961130480